



20 Orbit Drive WHITTINGTON, VIC



Neat Family Home in a Great Location

Only moments from primary and secondary schools, sporting facilities and quality shopping centres is this well located family home.

Features Include:

- ? Four bedrooms all with built in robes, master with ensuite
- ? Central bathroom with shower, bath and vanity
- ? Large living room
- ? Casual dining area and separate sitting room which could also be a fabulous work from home space
- ? Upgraded kitchen comes fully equipped with stainless steel appliances and plenty of bench and cupboard space
- ? Double garage
- ? Off street parking behind double gates
- ? Additional shed

Price: \$490.00 per week
Inspect: Saturday, 26th October 2024 9:40 - 9:50
 Tuesday, 29th October 2024 1:00 - 1:10

Property Type: House
Date Available: Friday, 1st November 2024
Land: 775.96 m²

HAYDEN

Anna Vines

Sarah Di Giandomenico

0493 223 192

anna@haydengeelong.com.au rentals.geelong@raywhite.com

Floor Plan

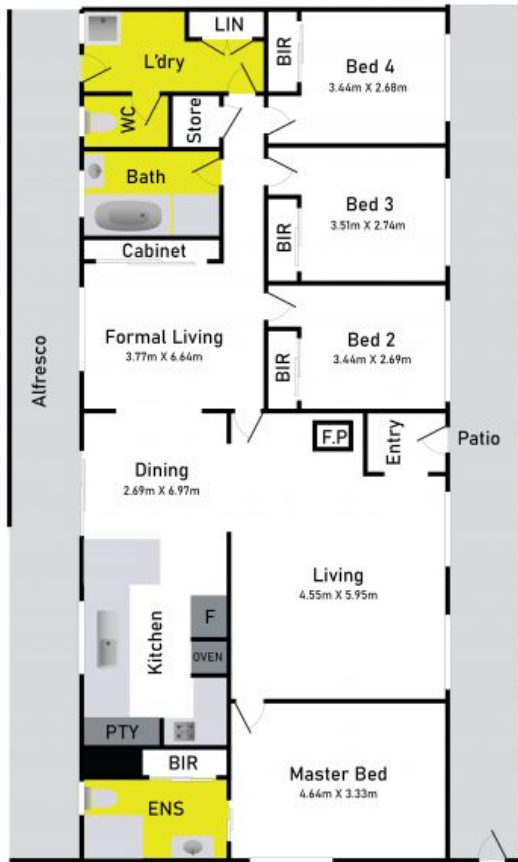

Site Plan

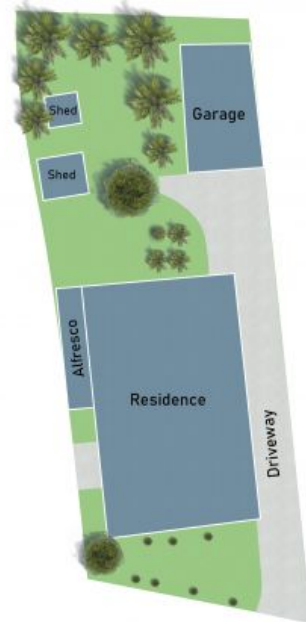

20 Orbit Drive, Whittington

* Whilst Ray White Geelong has made every attempt to ensure the accuracy of the floor plan contained here, measurements are approximate and no responsibility is taken for any error, omission or misstatement. This plan is for illustrative purposes only.