



2 Birdie Avenue ANGLESEA, VIC



3



1

Bright Country Beach House

Discover the unique appeal of this eclectic Anglesea beach house, perfectly situated at 2 Birdie Avenue. This delightful property offers a relaxed country coastal lifestyle with all the comforts you desire.

Enjoy the natural light throughout the day with a prime north-facing orientation, creating a bright and welcoming atmosphere and relish in the already established gardens, offering a serene retreat as soon as you move in.

Just a short stroll away from the Anglesea Golf Course, this location is ideal for golf enthusiasts. Enjoy easy access to the beach, local shops, cafes, popular bush walking/hiking trails and all the amenities that make Anglesea a sought-after destination ? all only minutes away!

Price: \$1,100,000 - \$1,200,000

Property Type: House

Land: 582 m2

HAYDEN

Darcy Bennett

0468427359

darcyb@hayden.com.au

Vijay Moody-Ratcliffe

0400691762

vijaym@hayden.com.au

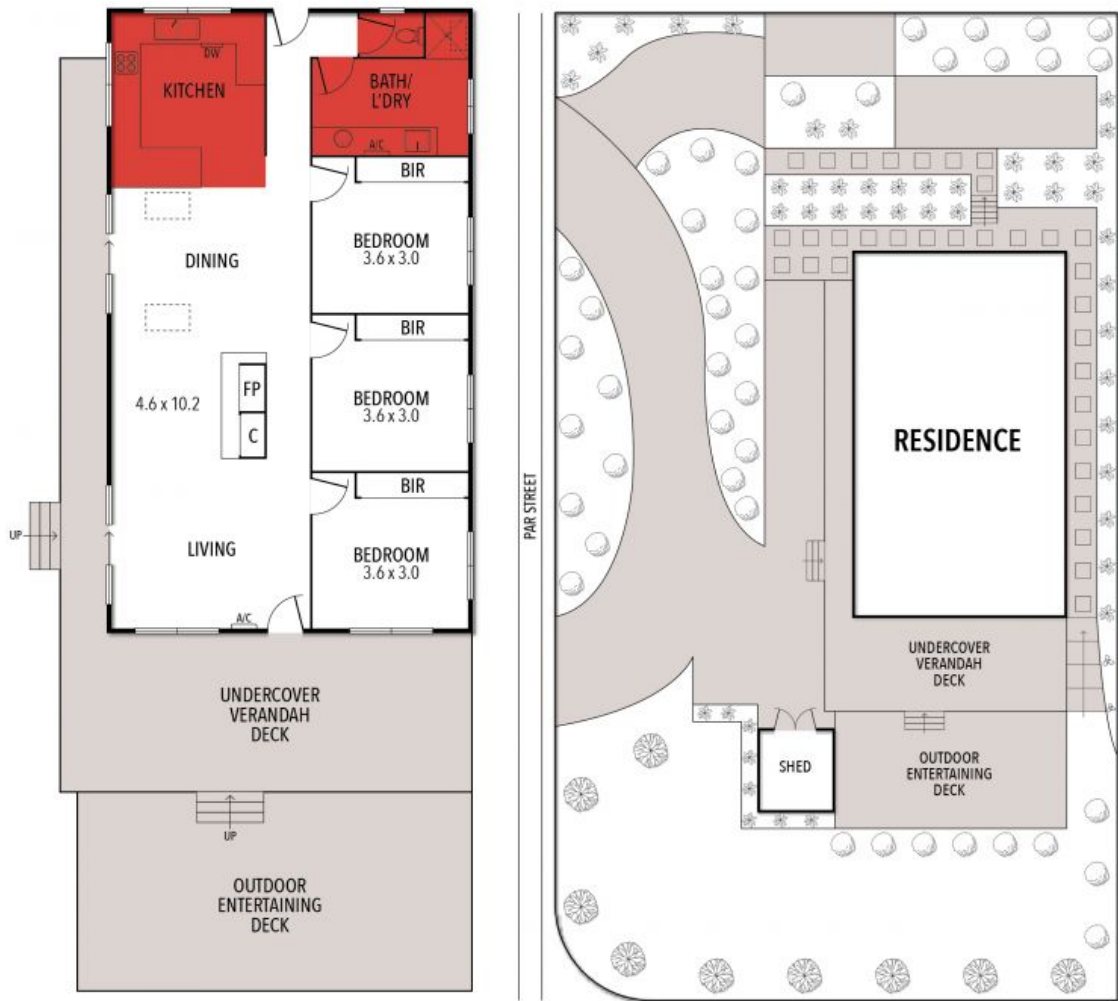

THE ABOVE PLAN IS AN ARTIST'S IMPRESSION ONLY, IT INCLUDES ELEMENTS THAT ARE FOR DISPLAY PURPOSES ONLY AND MAY NOT BE TO SCALE. LANDSCAPING SHOWN IS INDICATIVE ONLY. DIMENSIONS ARE APPROXIMATE.