



1/13 Longview Avenue LEOPOLD, VIC



2



1

Low-Maintenance Bliss A Heartbeat From The Dorothy St Shops!

Have you been dreaming of low-maintenance living but don't want to compromise on space? Located a short walk to the Dorothy Street shops, this beautifully updated home is the one for you!

Two bedrooms with built-in robes share close access to the updated bathroom, while the laundry and separate toilet complete the layout. A new split-system air conditioner provides comfort. The secure courtyard is home to a grassed area, while the single carport provides parking.

Price: \$485,000 - \$530,000

Property Type: Unit

Land: 239 m2

HAYDEN

Karen Purcell

0448510143

karenp@haydenleopold.com.au

David Pemberton

0419874029

david@haydenleopold.com.au

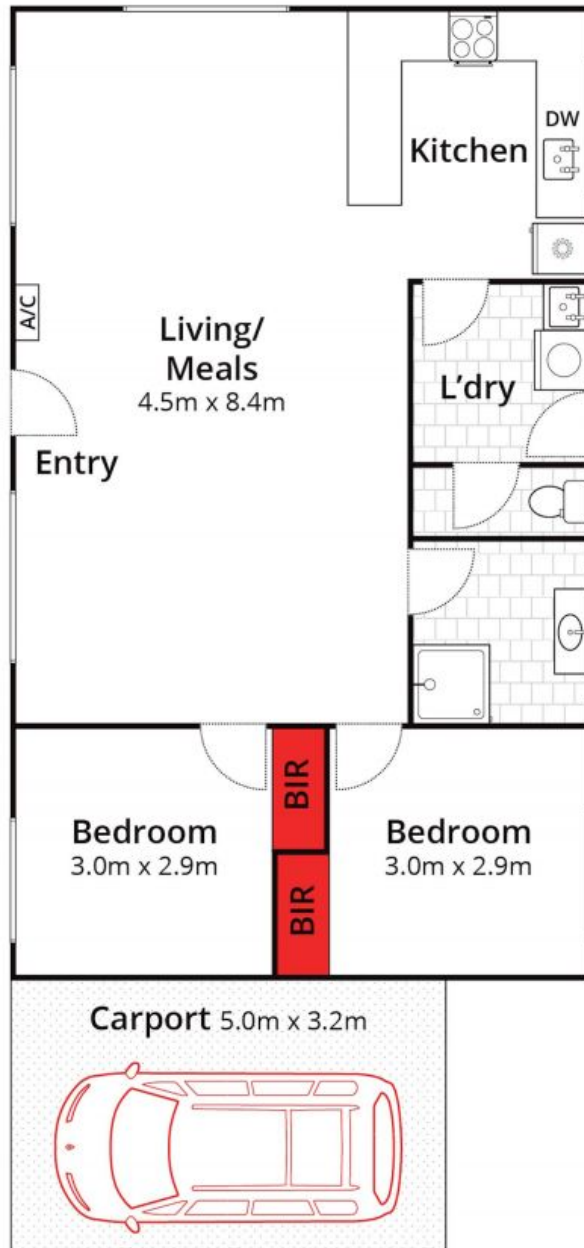

Whilst bwrn.com.au has made every attempt to ensure the accuracy of the floor plan contained here, measurements are approximate and no responsibility is taken for any error, omission, or mis-statement. This plan is for illustrative purposes only.



1/13 Longview Avenue, Leopold

HAYDEN

1/13 Longview Avenue

LEOPOLD, VIC