



28 Newhaven Avenue ST ALBANS PARK, VIC



4



2



2

Beautiful family home in Quiet Location

Welcome to 28 Newhaven Avenue, St Albans Park! This stunning property offers a perfect blend of modern elegance and comfortable living. Situated on a generous land area of 557sqm, this spacious house boasts 4 bedrooms and 2 bathrooms, providing ample space for a growing family or those looking for extra room.

Price: \$630,000 - \$650,000

Property Type: House

Land: 557 m2

HAYDEN

Glenn Hardman

0419006480

glenn@haydengeelong.com.au

28 NEWHAVEN AVENUE, SAINT ALBANS PARK

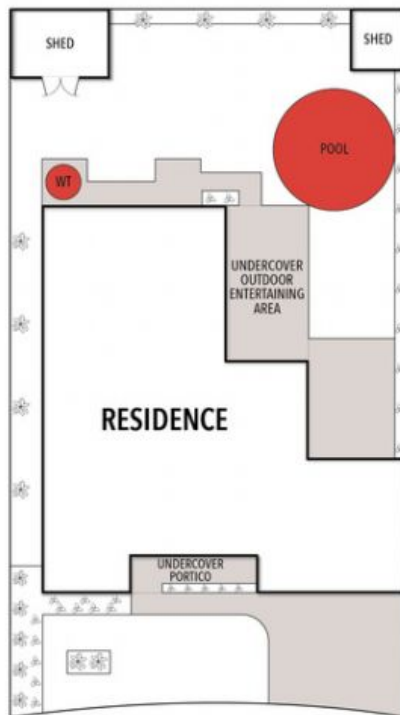

THE ABOVE PLAN IS AN ARTIST'S IMPRESSION ONLY, IT INCLUDES ELEMENTS THAT ARE FOR DISPLAY PURPOSES ONLY AND MAY NOT BE TO SCALE. LANDSCAPING SHOWN IS INDICATIVE ONLY. DIMENSIONS ARE APPROXIMATE.