



28 Claremont Drive LEOPOLD, VIC



3



1



2

Overflowing With Character & Charm!

You'll be charmed the moment you lay eyes on this family home!

It's clear to see that this property has been well-loved over the years, with slate flooring and timber ceilings adding character to the welcoming interiors. You'll love that cottage-style gardens surround the entire home, providing a picturesque outlook through every window. A wood heater creates a cosy ambience in the living room, which flows into the generous study nook. Boasting a built-in desk, this setting makes working from home a breeze.

The dining/kitchen zone opens onto the north-facing garden, with the kitchen featuring a built-in pantry, stainless steel dishwasher and cooking appliances. Interior lighting with dimmer switches enables you to create the perfect mood for working or relaxing in the living zones. Three bedrooms with built-in robes (main also with walk-in robe) share close access to the bathroom, while the laundry and separate toilet complete the layout. Other feat

Price: \$630,000 - \$670,000

Property Type: House

Land: 687 m2

HAYDEN

Karen Purcell

0448510143

karenp@haydenleopold.com.au

David Pemberton

0419874029

david@haydenleopold.com.au

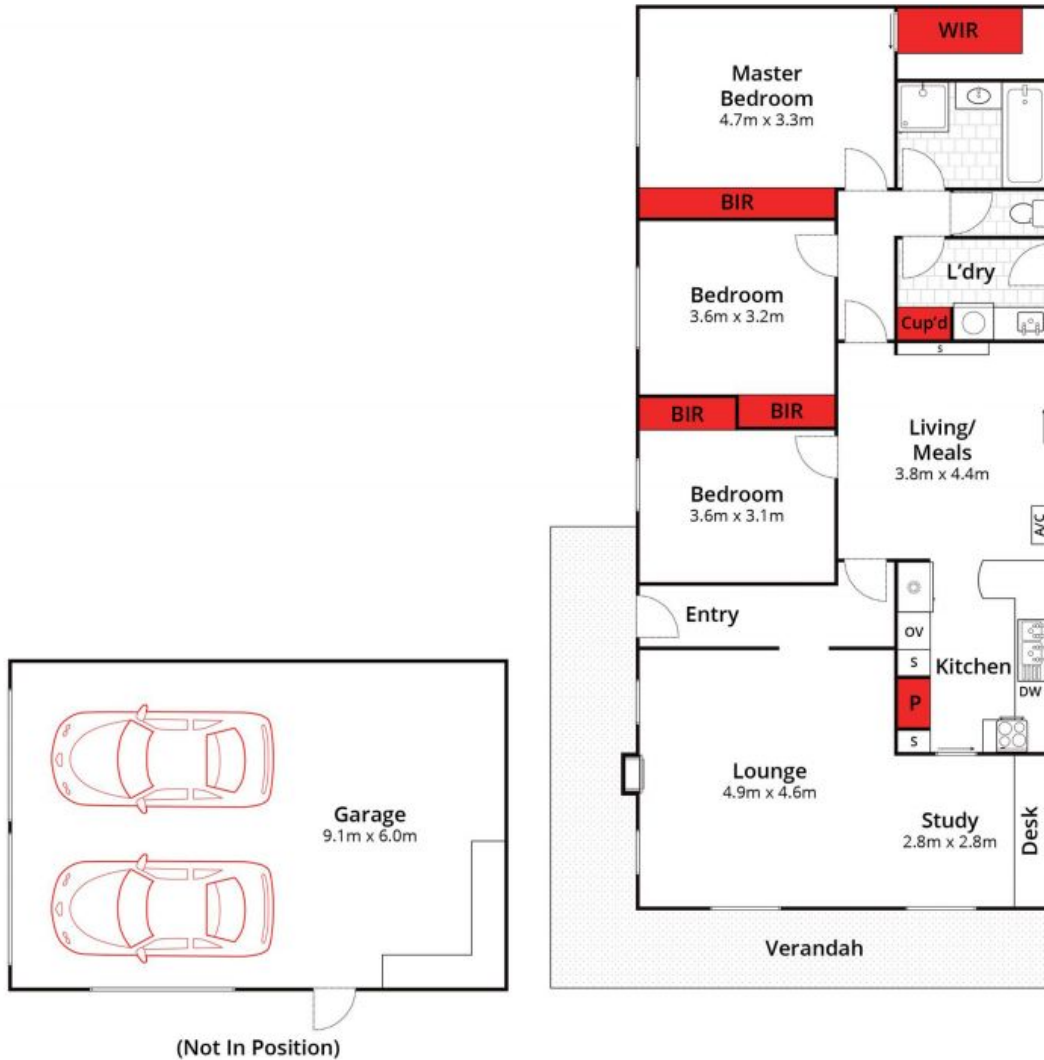

Whilst bwrn.com.au has made every attempt to ensure the accuracy of the floor plan contained here, measurements are approximate and no responsibility is taken for any error, omission, or mis-statement. This plan is for illustrative purposes only.



28 Claremont Drive, Leopold

HAYDEN

28 Claremont Drive

LEOPOLD, VIC