



24 Heytesbury Drive LEOPOLD, VIC



The Ideal Family Home! Contact for Private Inspection

Have you been searching for the ultimate family home? Showcasing a spacious outdoor entertaining zone, a solar-heated swimming pool, and a frepit zone, this extremely low maintenance home is simply stunning!

Price: \$750,000 - \$800,000
Property Type: House
Land: 676 m2

HAYDEN

Karen Purcell

0448510143

karenp@haydenleopold.com.au

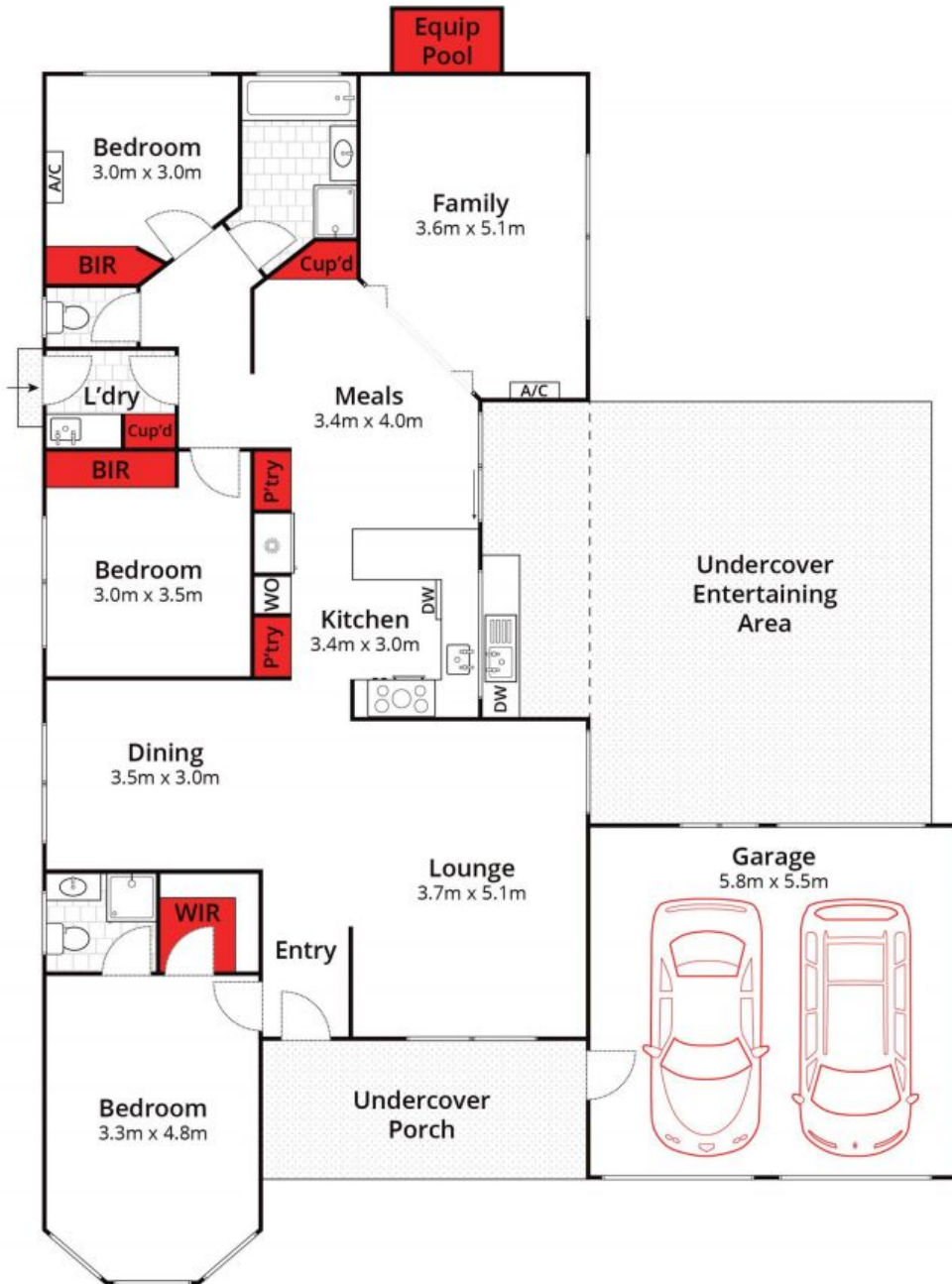

Whilst bwrn.com.au has made every attempt to ensure the accuracy of the floor plan contained here, measurements are approximate and no responsibility is taken for any error, omission, or mis-statement. This plan is for illustrative purposes only.

24 Heytesbury Drive, Leopold

HAYDEN

24 Heytesbury Drive

LEOPOLD, VIC